



CJLINE

400°C/2h in line ventilation units

Construction characteristics

- Series with LGAI certification, in accordance with 12101-3 European Standard.
- In line ventilation unit, equipped with backward curved impeller, whose main feature is the linear air circulation between inlet and outlet, which facilitates installation and dismantling without having to handle the installation ducts. Specially designed to be installed between rectangular ducts.



2-speed motors

Technical characteristics

Model	Velocity (r/min)	Max. admissible current (A)		Installed power (kW)	Max. airflow (m3/h)	Sound level pressure dB(A)	Approx. weight Kg.
		230V	400V				
CJLINE-1131-4T	1350	1,32	0,76	0,25	1920	51	38,8
CJLINE-1131-4/8T	1400/700		0,70 / 0,30	0,25 / 0,06	1920 / 960	51 / 36	41,3
CJLINE-1235-4T	1350	1,32	0,76	0,25	3550	56	53,8
CJLINE-1235-4/8T	1400/700		0,70 / 0,30	0,25 / 0,06	3550 / 1775	56 / 41	56,3
CJLINE-1235-6T	890	1,35	0,77	0,18	2300	50	54,8
CJLINE-1640-4T	1370	1,78	1,03	0,37	4800	61	65,0
CJLINE-1640-4/8T	1440/700		1,05 / 0,50	0,37 / 0,10	4800 / 2400	61 / 46	68,4
CJLINE-1640-6T	890	1,67	0,96	0,25	2950	54	65,8
CJLINE-1845-4T	1395	3,22	1,86	0,75	6700	65	82,4
CJLINE-1845-4/8T	1430/710		2,00 / 0,90	0,75 / 0,15	6700 / 3350	65 / 50	84,5
CJLINE-1845-6T	925	1,93	1,11	0,37	4360	57	81,3
CJLINE-1856-6T	920	2,80	1,61	0,55	7720	59	142,3
CJLINE-1856-6/12T	915/465		1,45 / 0,95	0,50 / 0,10	7720 / 3860	59 / 44	142,0
CJLINE-1856-8T	700	1,60	0,92	0,25	5800	52	141,5
CJLINE-2063-6T	910	3,39	1,95	0,75	11100	61	189,0
CJLINE-2063-6/12T	935/435		2,20 / 0,87	0,75 / 0,15	11100 / 5550	61 / 46	188,0
CJLINE-2063-8T	685	2,50	1,44	0,37	7730	54	188,0
CJLINE-2271-6T	940	7,48	4,30	1,50	14300	65	209,0
CJLINE-2271-6/12T	970/470		4,60 / 1,90	1,50 / 0,25	14300 / 7150	65 / 50	225,0
CJLINE-2271-8T	700	4,05	2,33	0,75	9900	57	207,0
CJLINE-2880-6T	935	12,20	7,00	3,00	22800	67	295,0
CJLINE-2880-6/12T	960/470		8,20 / 3,40	3,00 / 0,55	22800 / 11400	67 / 52	288,0
CJLINE-2880-8T	710	10,10	5,83	2,20	17200	58	274,0

Acoustic characteristics

The values shown are calculated using free-field sound pressure levels in dB (A), at a distance equivalent to twice the fan span plus the impeller diameter, with a minimum of 1.5 m.

Sound power spectrum Lw(A) in dB(A) by frequency band in Hz.

Model	63	125	250	500	1000	2000	4000	8000	Model	63	125	250	500	1000	2000	4000	8000
1131-4	42	51	57	56	60	60	52	46	1856-8	51	57	62	63	66	65	58	53
1131-8	27	36	42	41	45	45	37	31	1856-12	43	49	54	55	58	57	50	45
1235-4	49	58	64	63	67	66	59	53	2063-6	60	66	72	72	76	76	68	61
1235-6	43	52	58	57	61	60	53	47	2063-8	53	59	65	65	69	69	61	54
1235-8	34	43	59	48	52	51	44	38	2063-12	45	51	57	57	61	61	53	46
1640-4	56	62	67	68	71	73	65	59	2271-6	64	70	76	76	80	80	72	65
1640-6	49	55	60	61	64	66	58	52	2271-8	56	62	68	68	72	72	64	57
1640-8	41	47	52	53	56	58	50	44	2271-12	49	55	61	61	65	65	57	50
1845-4	60	66	71	72	75	77	69	63	2880-6	66	72	78	78	82	82	74	67
1845-6	52	58	63	64	67	69	61	55	2880-8	57	63	69	69	73	73	65	58
1845-8	45	51	56	57	60	62	54	48	2880-12	51	57	63	63	67	67	59	52
1856-6	58	64	69	70	73	72	65	60									

CJLINE

Dimensions mm

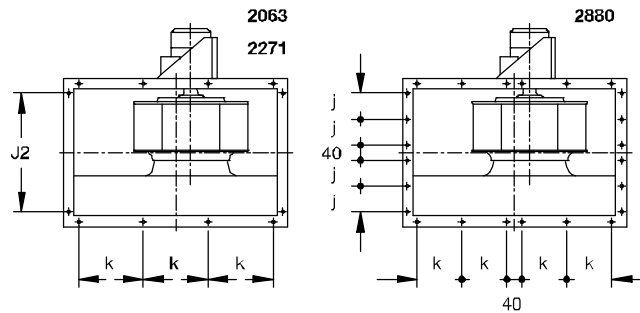
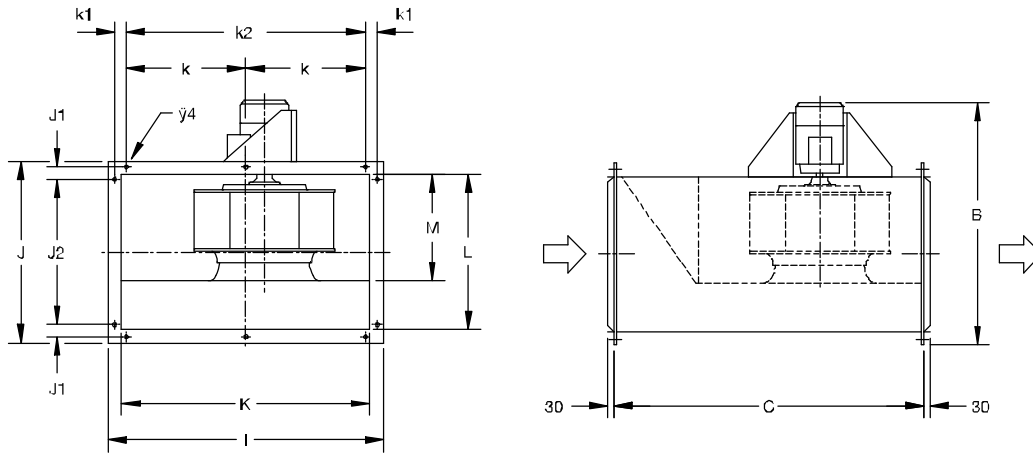

Model	B	C	I	J	j	J1	J2	K	k	k1	k2	L	M
CJLINE-1131	705	710	630	520	-	97,5	290	560	-	72,5	450	450	175
CJLINE-1235	755	800	690	570	-	97,5	340	620	-	72,5	510	500	213
CJLINE-1640	815	900	780	630	-	97,5	400	710	-	72,5	600	560	262
CJLINE-1845	905	1000	870	700	-	97,5	470	800	-	72,5	690	630	290
CJLINE-1856	1075	1250	1070	870	-	97,5	640	1000	445	72,5	890	800	378
CJLINE-2063	1190	1400	1190	970	-	97,5	740	1120	337	72	1011	900	405
CJLINE-2271	1280	1400	1260	970	-	97,5	740	1190	360	72,5	1080	900	455
CJLINE-2880	1410	1500	1320	1070	227	43,5	948	1250	289	44,5	1196	1000	490





CJLINE

Characteristics Curves

Q = Airflow in m³/h. and m³/s.
Pe = Static pressure in mm.c.a. and Pa.

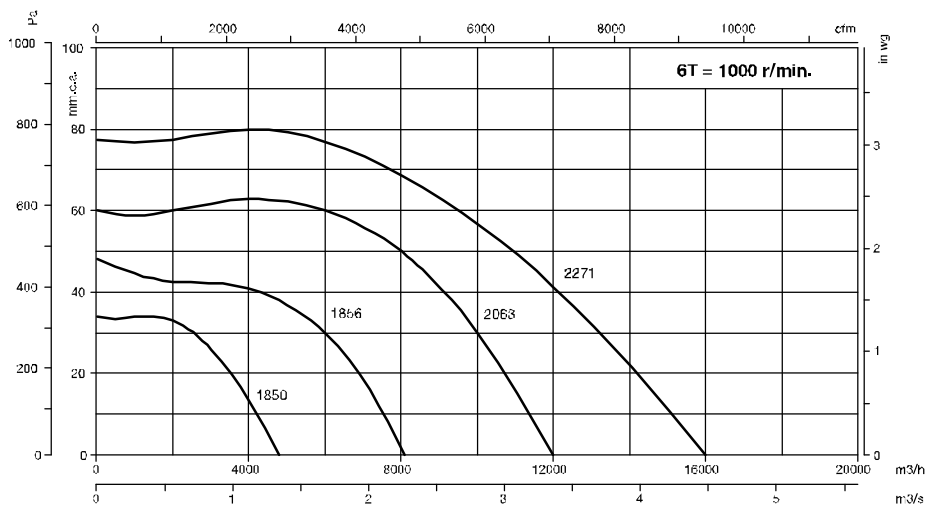
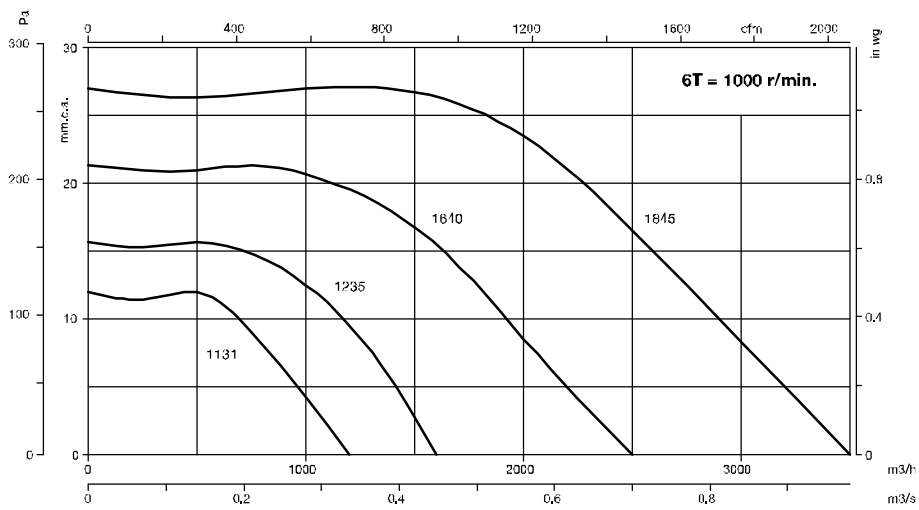
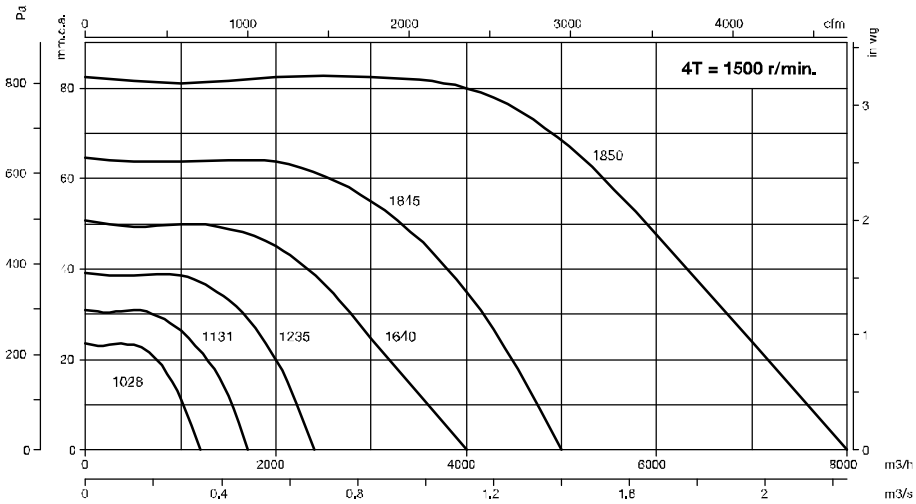



CJLINE

Characteristics Curves

Q = Airflow in m³/h. and m³/s.
 Pe = Static pressure in mm.c.a. and Pa.

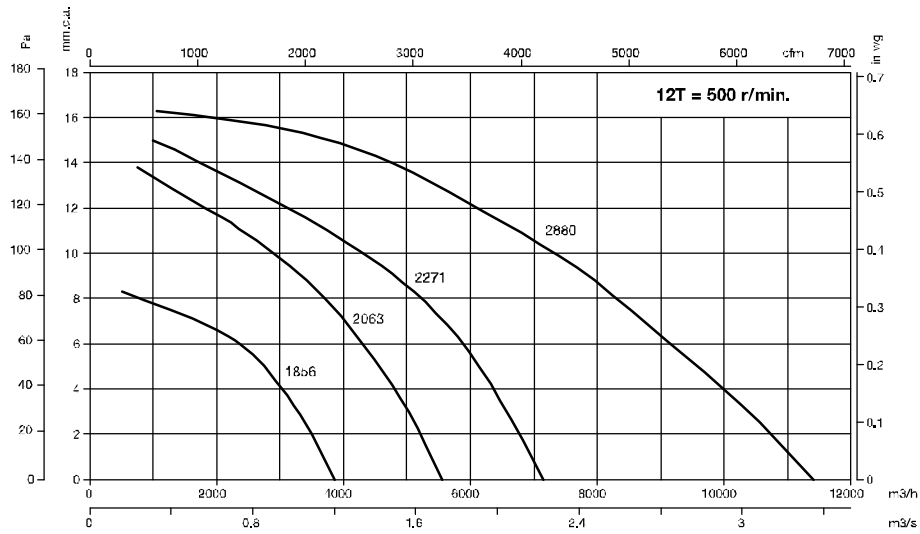
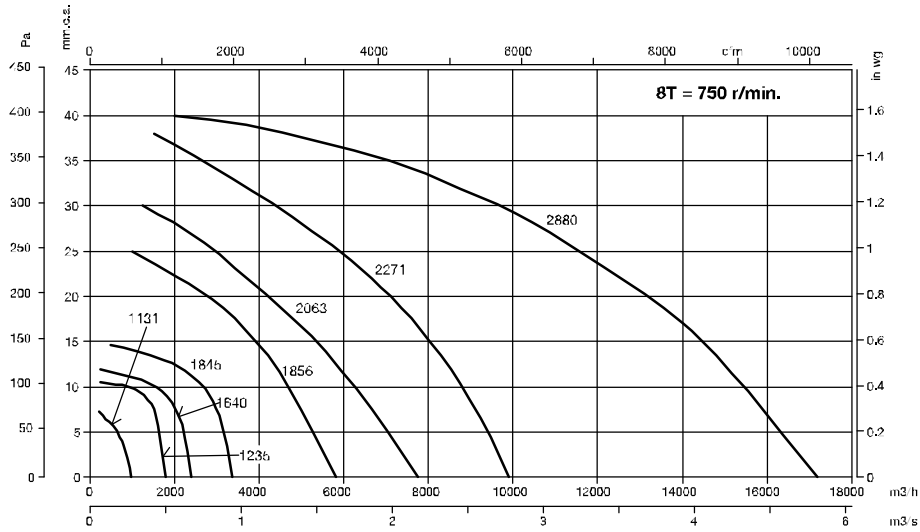

Accessories

See pages 248 onwards.



TAC



VIS

